

COLEHERNE ROAD

CHELSEA SW10

FARRAR



This is a well presented flat in a period terrace house boasting high ceilings being on the first floor. The flat currently comprises two bedrooms with built in storage, a family bathroom, separate kitchen with access to a roof terrace and a generous reception room which is perfect for entertaining having space for a separate dining area. It has lovely westerly views down Wharfedale Street which offer plenty of light into the internal space. Earls Court underground station (Circle, District) is close by as are all the local amenities along Old Brompton Road and Earls Court Road.



- Period Building
- First Floor
- High Ceilings
- South West Facing
- Roof Terrace
- Central Location

Approximate Gross Internal Area
670 sq ft / 62.3 sq m

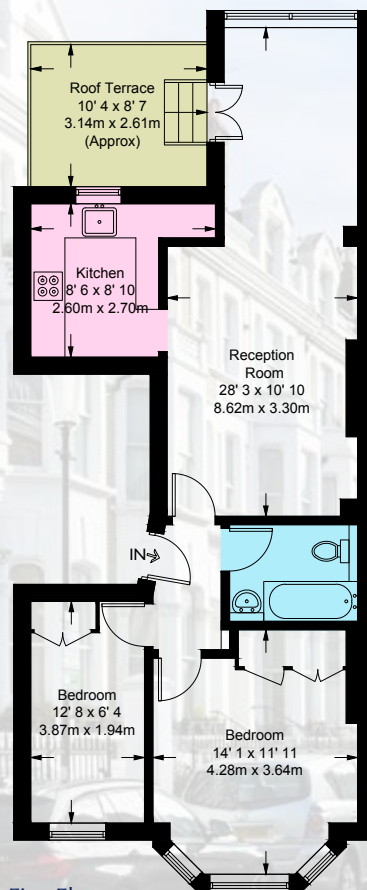

First Floor

TERMS

(As agreed by our client)

Tenure Leasehold - Approx. 88 years remaining

Service Charge £4,900 (including contribution to sinking fund)

Ground Rent £75 per annum

Local Authority The Royal Borough of Kensington & Chelsea

Asking Price £850,000



FARRAR

020 7244 4444
www.farrar.co.uk

NOTE: These particulars have been prepared to give a fair overall view of the property. They should not be considered confirmation of the property's structural condition nor that any services, appliances, equipment or facilities are in good working order. Descriptions are given as opinion, not as statement of fact and measurements are approximate, as a guide only. Photograph/s show only part/s of the property and it should not be assumed that contents/furnishings/furniture shown are included in the sale. Purchasers should seek verification on any points fundamental to a purchase prior to purchase. The EPC for this property will be presented along with this brochure. If it has become detached or is not provided please contact the office who will supply you with a copy.