

PHILBEACH GARDENS

CHELSEA SW5

FARRAR



This is an immaculate two doubled bedroom second floor flat.in this laterally converted building. The flat has made an excellent rental investment for our client and is approached via newly refurbished common parts, this lovely flat would also make a fantastic central London home. Philbeach Gardens is a popular Victorian terraced street quietly positioned between Warwick Road and Old Brompton Road and is conveniently positioned for access to Earls Court underground station. Viewing is highly recommended.

- Two Double Bedrooms
- Good Condition
- Share of Freehold
- Period Building

TERMS

(As agreed by our client)

Tenure Share of Freehold

Service Charge £2,500 per annum approximately

Local Authority The Royal Borough of Kensington & Chelsea

Asking Price £785,000



Approximate Gross Internal Area
657 sq ft / 61 sq m

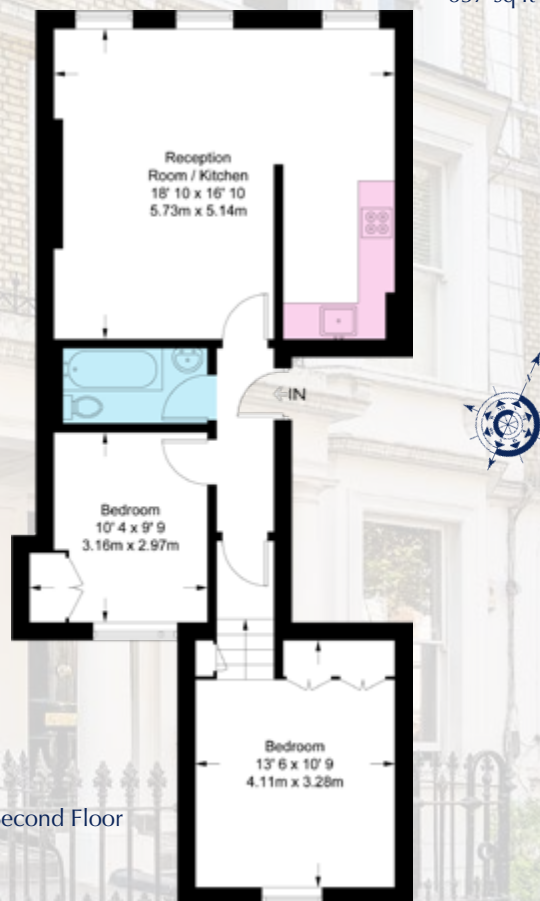

FARRAR

020 7244 4444

www.farrar.co.uk

NOTE: These particulars have been prepared to give a fair overall view of the property. They should not be considered confirmation of the property's structural condition nor that any services, appliances, equipment or facilities are in good working order. Descriptions are given as opinion, not as statement of fact and measurements are approximate, as a guide only. Photograph/s show only part/s of the property and it should not be assumed that contents/furnishings/furniture shown are included in the sale. Purchasers should seek verification on any points fundamental to a purchase prior to purchase. The EPC for this property will be presented along with this brochure. If it has become detached or is not provided please contact the office who will supply you with a copy.